

SPECIFICATIONS:

Attach Points on 8" centers
 Hydraulic operations
 Aluminum construction
 Stainless steel fittings
 Skid lift: 3 1/2"
 Shipping dimensions: 38" x 13" x 26"
 Weight: 91 lbs
 Lift height: 4"
 Finish: Powder Coat White or Military Request
 Max Weight Capacity: 4300 lbs

Page 1 of 2

NSN 4920-01-480-6402

MODEL: BCW-4300A

ITEM NO.	PART NUMBER	DESCRIPTION	NO. REQ.
1	W-43-00A	FRAME ASSEMBLY	1
2	W-43-05AR	RIGHT GUIDE	2
3	W-43-04	AXLE SLIDE	2
4	BOLT 5/16 - 24 X 1 1/2 SS	BOLT STAINLESS	16
5	WASHER SAE 5/16 SS	WASHER STAINLESS	16
6	NUT LOCK 5/16 - 24 SS	NUT STAINLESS	16
7	W-43-12A	FORK ASSEMBLY	2
8	WASHER LOCK 1/4 HCLW SS	LOCK WASHER	3
9	WASHER FENDER 1/4 SS	FENDER WASHER	1
10	PIN COTTER 1/8 X 1 3/4 SS	COTTER PIN	6
11	HG-2	GRIP	1
12	W-5.00 X 5 14 PLY TW	TIRE	2
13	W-5.00 X 5 TB	TUBE	2
14	W-43-13	JACK BASE	1
15	W-43-02	3 TON JACK ASM	1
16	W-43-09-03	PAD	1
NS	W-43-02-01	JACK KEEPER	1
NS	BOLT ALLEN 6-32 X 3/8	SHCS SS BOLT	1
17	SCREW BUTTON 4-40 X 3/8 SS	BHCS	4
18	W-43-14	HANDLE ASSEMBLY	1
19	W-43-12-06	AXLE	2
20	W-43-10S A	ARM ASSEMBLY	2
21	W-43-09 A	NUT PLATE ASSEMBLY	1
22	BOLT 5/16-24x1 3/4 SS	BOLT	4
23	BOLT 1/4-20 X 3/4 SHCS SS	ALLEN HEAD BOLT	2
24	WASHER 3/4 USS	WASHER	2
25	W-43-15A	WHEEL BUSHING	4
26	40-77A	WHEEL	2
27	BOLT 1/4-20 X 1 SS	BOLT	1
28	W-43-HCA	DUST CAP	2

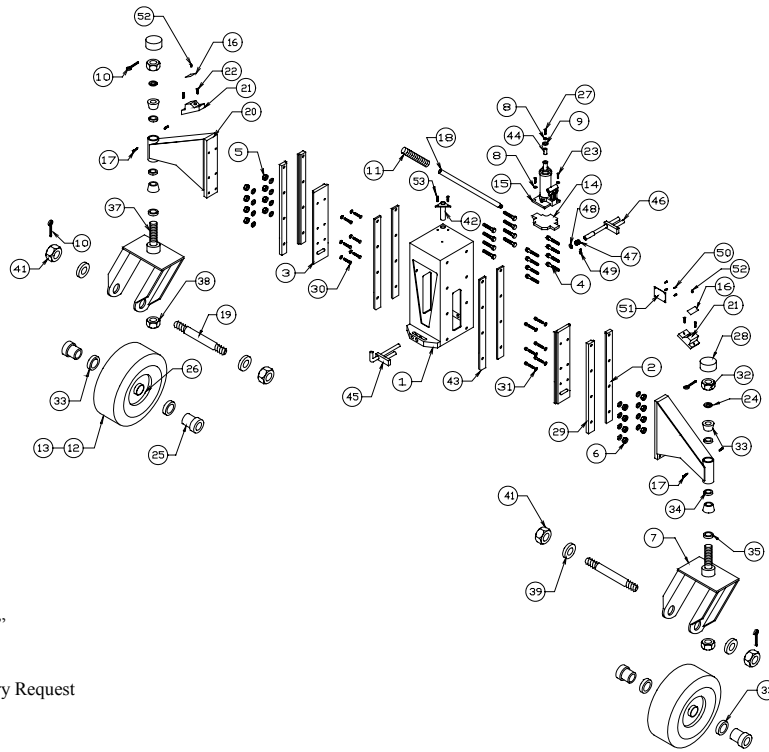

SPECIFICATIONS:

Attach Points on 8" centers
 Hydraulic operations
 Aluminum construction
 Stainless steel fittings
 Skid lift: 3½"
 Shipping dimensions: 38" x 13" x 26"
 Weight: 91 lbs
 Lift height: 4"
 Finish: Powder Coat White or Military Request
 Max Weight Capacity: 4300 lbs

Page 2 of 2

NSN 4920-01-480-6402

MODEL: BCW-4300A

ITEM NO.	PART NUMBER	DESCRIPTION	NO. REQ.
29	W-43-05AL	LEFT GUIDE	2
30	BOLT ALLEN 3/8-24 X 1	SHCS BOLT	12
31	WASHER HIGH COLLAR LOCK 3/8 SS	LOCK WASHER	12
32	NUT ¾-16 SLOTTED	NUT SLOTTED	2
33	LM67048	BEARING CONE	2
34	LM67010	BEARING CUP	2
35	CR17257	SEAL	2
37	W-43-12-01A	CASTER FORK SPINDLE	2
38	AN364-1614C	NUT	2
39	WASHER SAE ¾ SS	SAE WASHER	4
41	NUT CASTLE ¾-16 SS	CASTLE NUT	4
42	W-43-11	HANDLE HOLDER	1
43	W-43-03A	WEAR PLATE	4
44	W-43-06A	SPACER	1
45	W-43-20	HANDLE PLUNGER	1
46	W-43-21	INNER PLUNGER	1
47	10417	SPRING	1
48	AN960-616	WASHER	1
49	SCREW SET 10-32 X ¼	SET SCREW	1
50	SCREW DRIVE #6 X ¼	DRIVE SCREW	4
51	W-4300NP	NAME PLATE	1
52	SCREW BUTTON 10-32 X ½ SS	BHCS	2
53	SCREW BUTTON 10-32 X ¾ SS	BHCS	2
NS	603500	JACK REPAIR KIT	1
NS	602065	JACK KNOB ASSEMBLY	1