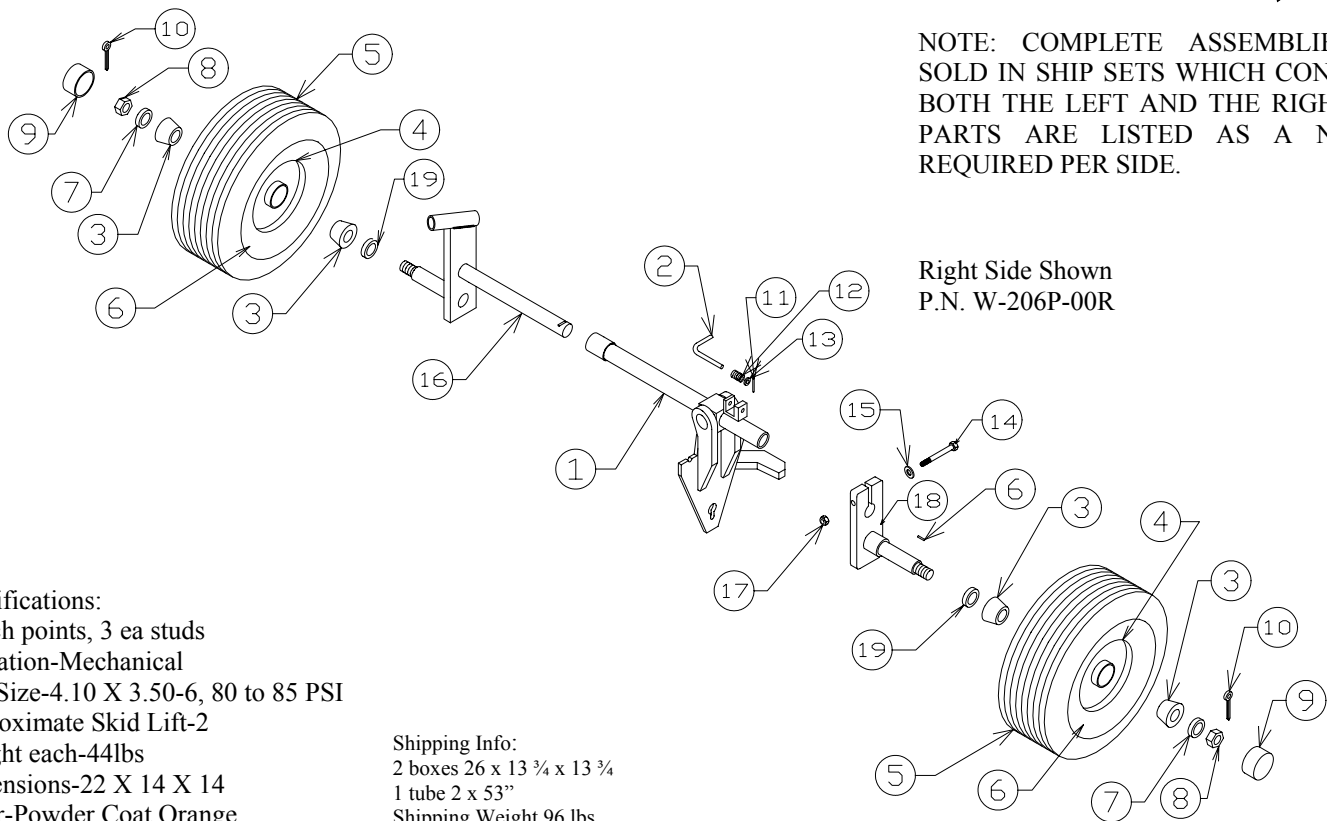

NOTE: COMPLETE ASSEMBLIES ARE SOLD IN SHIP SETS WHICH CONSIST OF BOTH THE LEFT AND THE RIGHT SIDE, PARTS ARE LISTED AS A NUMBER REQUIRED PER SIDE.

**Specifications:**

Attach points, 3 ea studs

Operation-Mechanical

Tire Size-4.10 X 3.50-6, 80 to 85 PSI

Approximate Skid Lift-2

Weight each-44lbs

Dimensions-22 X 14 X 14

Color-Powder Coat Orange

Shipping Info:

2 boxes 26 x 13 3/4 x 13 3/4

1 tube 2 x 53"

Shipping Weight 96 lbs.

ELIGIBLE AIRCRAFT:
BELL JET RANGER PAN FLOATS

MODEL:
BDW-206PF

Page 1 of 1

ITEM NO	PART NUMBER	DESCRIPTION	NO REQ.
1	W-206P-13L	LEFT WELDED ASSEMBLY	1
1	W-206P-13R	RIGHT WELDED ASSEMBLY	1
2	W-U-101	L-PIN	1
3	L44643	WHEEL BEARING	4
4	W-4.10/3.50 X 6 TW	WHEEL ASSEMBLY W/ TIRE AND BRG	2
5	W-4.10/3.50 X 6 TR	TIRE 6 PLY	2
6	W-4.10/3.50 X 6 TB	TUBE	2
7	WASHER SAE 3/4	WASHER	4
8	NUT SLOTTED 3/4-16	SLOTTED NUT	2
9	HC-1	HUB CAP	2
10	PIN COTTER 1/8 X 1 1/2	COTTER PIN	2
11	PIN ROLL 3/32 X 5/8	ROLL PIN	2
12	S-264	SPRING	1
13	AN960-516	WASHER	1
14	BOLT 5/16-24 X 2 1/2	BOLT	1
15	AN960-516L	WASHER	1
16	W-206P-11L	LEFT OUTER ARM	1
16	W-206P-11R	RIGHT OUTER ARM	1
17	NUT LOCK 5/16-24	LOCK NUT	1
18	W-206P-12L	LEFT INNER ARM	1
18	W-206P-12R	RIGHT INNER ARM	1
19	VB12192	SEAL SPINDLE 1.25 DIA	2
	W-U-110	HANDLE ASSEMBLY (NOT SHOWN)	1
	W-LPK	L-PIN KIT (ITEMS 2, 11, 12, 13)	
	W-LPRK	REPAIR KIT (W-LPK + U-100 HOLDER)	