

Shipping Info:  
 2 boxes 24x22x18 (5.5 ft.<sup>3</sup> ea.)  
 Total : Weight 105 lbs. (11 ft.<sup>3</sup>)

EQUIVALENT :  
 SN 1730-01-133-9204  
 214-706-104-101/105  
 214-706-104-003 (OLD STYLE)  
 212-050-200-105/107  
 204-050-200-005/101

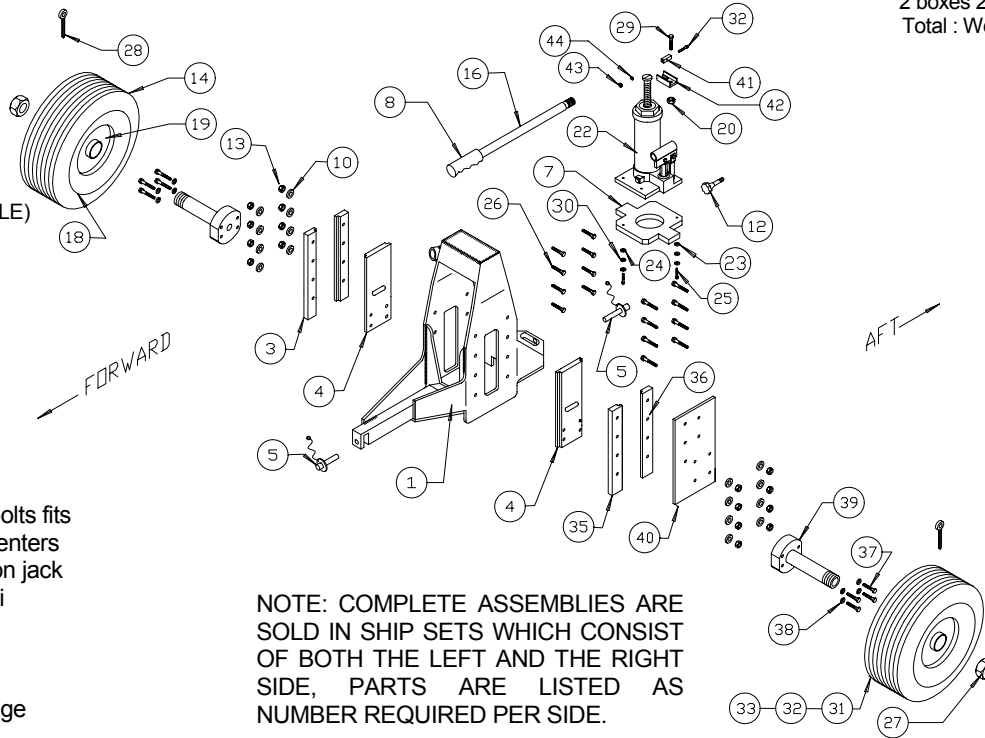

Specifications  
 Skid tube dia. 4.00"  
 Attach points, 2 ea. eye bolts fits  
 both 16.25" & 18.00" centers  
 Operation - Hydraulic 8 ton jack  
 Tire size - 18x5.5, 105 psi  
 Approximate skid lift 3"  
 Weight each 95 lbs.  
 Dimensions 19x20x21  
 Color, Powder Coat Orange

NOTE: COMPLETE ASSEMBLIES ARE SOLD IN SHIP SETS WHICH CONSIST OF BOTH THE LEFT AND THE RIGHT SIDE, PARTS ARE LISTED AS NUMBER REQUIRED PER SIDE.

Page 1 of 2

BELL 214ST

MODEL: BDW-214ST

ITEM NO.	PART NUMBER	DESCRIPTION	NO REQ
1	W-214ST-00L	WELDED BASE ASM.	1
1	W-214ST-00R	WELDED BASE ASM	1
2	WASHER LOCK 3/8	3/8 LOCK WASHER	8
3	W-245-05B	GUIDE	2
4	W-245-04B	AXLE SLIDE	2
5	CL8BLPB2.00C	BALL LOCK PIN -	2
6	BOLT 3/8-24 X 1¼	BOLT	8
7	W-245-07D	JACK BASE	1
8	HG-1	HANDLE GRIP	1
9	W-245-30	SPRING KEEPER	1
10	WASHER SAE 5/16	WASHER	16
11	S-264	SPRING	1
12	W-245-13-00	JACK RELEASE KNOB ASM.	1
13	NUT LOCK 5/16-18	LOCK NUT	16
14	W-18 X 5.5 TR	8 PLY TIRE	2
15	W-245-29	FRONT PIN	1
16	W-245-14-00	JACK HANDLE ASM.	1
17	W-245-11B	SPINDLE	2
18	W-5.30-8 TB	NON A/C USE TUBE	2
19	40-117A	WHEEL	2
20	NUT LOCK 1/4-20	LOCK NUT	1
21	W-245-28	U-C JACK CLIP	1
22	W-245-22C	8 TON JACK	1
23	WASHER USS 5/16	WASHER	2

Shipping Info:  
 2 boxes 24x22x18 (5.5 ft.<sup>3</sup> ea.)  
 Total : Weight 105 lbs. (11 ft.<sup>3</sup>)

EQUIVALENT :  
 SN 1730-01-133-9204  
 214-706-104-101/105  
 214-706-104-003 (OLD STYLE)  
 212-050-200-105/107  
 204-050-200-005/101

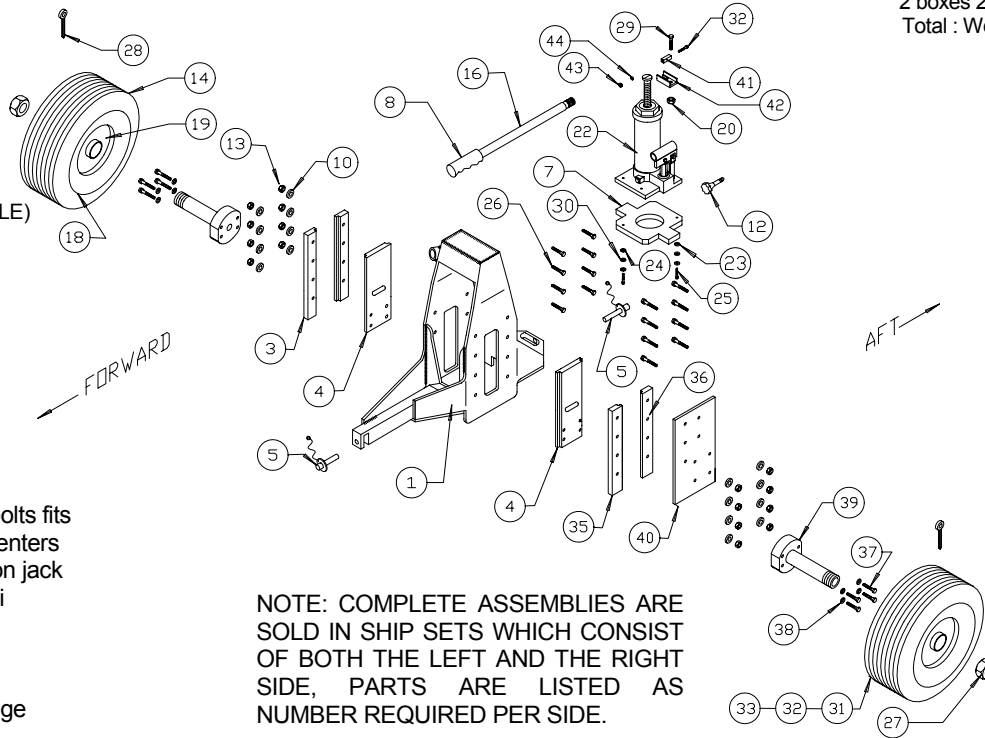

Specifications  
 Skid tube dia. 4.00"  
 Attach points, 2 ea. eye bolts fits  
 both 16.25" & 18.00" centers  
 Operation - Hydraulic 8 ton jack  
 Tire size - 18x5.5, 105 psi  
 Approximate skid lift 3"  
 Weight each 95 lbs.  
 Dimensions 19x20x21  
 Color, Powder Coat Orange

NOTE: COMPLETE ASSEMBLIES ARE SOLD IN SHIP SETS WHICH CONSIST OF BOTH THE LEFT AND THE RIGHT SIDE, PARTS ARE LISTED AS NUMBER REQUIRED PER SIDE.

Page 2 of 2

BELL 214ST

MODEL: BDW-214ST

ITEM NO.	PART NUMBER	DESCRIPTION	NO REQ
24	WASHER LOCK ¼	WASHER-SPLIT STYLE	2
25	MS35207-264	SCREW-PHILLIPS HEAD	2
26	BOLT 5/16-18 X 1¼	BOLT	16
27	W-245-25	CASTLE NUT	2
28	PIN COTTER 1/8 X 2 ½	COTTER PIN	2
29	SCREW ¼-20 X 1 ½	SCREW 82 ° COUNTERSINK	1
30	WASHER USS ¼	WASHER	2
31	40-77	5.00 x 5 WHEEL	1
32	W-5.00 X 5 TR	TIRE 10 PLY	1
33	W-5.00 X 5 TB	TUBE	1
34	W-245-04	AXLE SLIDE	1
35	W-245-05AL	LEFT GUIDE	1
36	W-245-05AR	RIGHT GUIDE	1
37	BOLT 5/16-18 X 1 ½	BOLT	4
38	WASHER LOCK 5/16	LOCK WASHER	4
39	W-245-11A	500 X 5 SPINDLE	1
40	W-214ST-01	OFFSET SPINDLE PLATE	1
41	W-245-28-01	CLIP JACK STOP	1
42	AN3-23A	BOLT	1
43	LOCKNUT 10-32	LOCKNUT	1
44	WASHER	WASHER	1
OPT.	W-18 X 5.5 TB	OPTIONAL A/C QUALITY TUBE	2