

BRACKETT AIRCRAFT COMPANY, INC.

7045 FLIGHTLINE DR., KINGMAN, AZ 86401 U.S.A. PH. 928-757-4005 FAX. 928-757-1948

Shipping Info:
2 boxes 24x22x18 (5.5 ft.³ ea.)
Total : Weight 200 lbs. (11 ft.³)

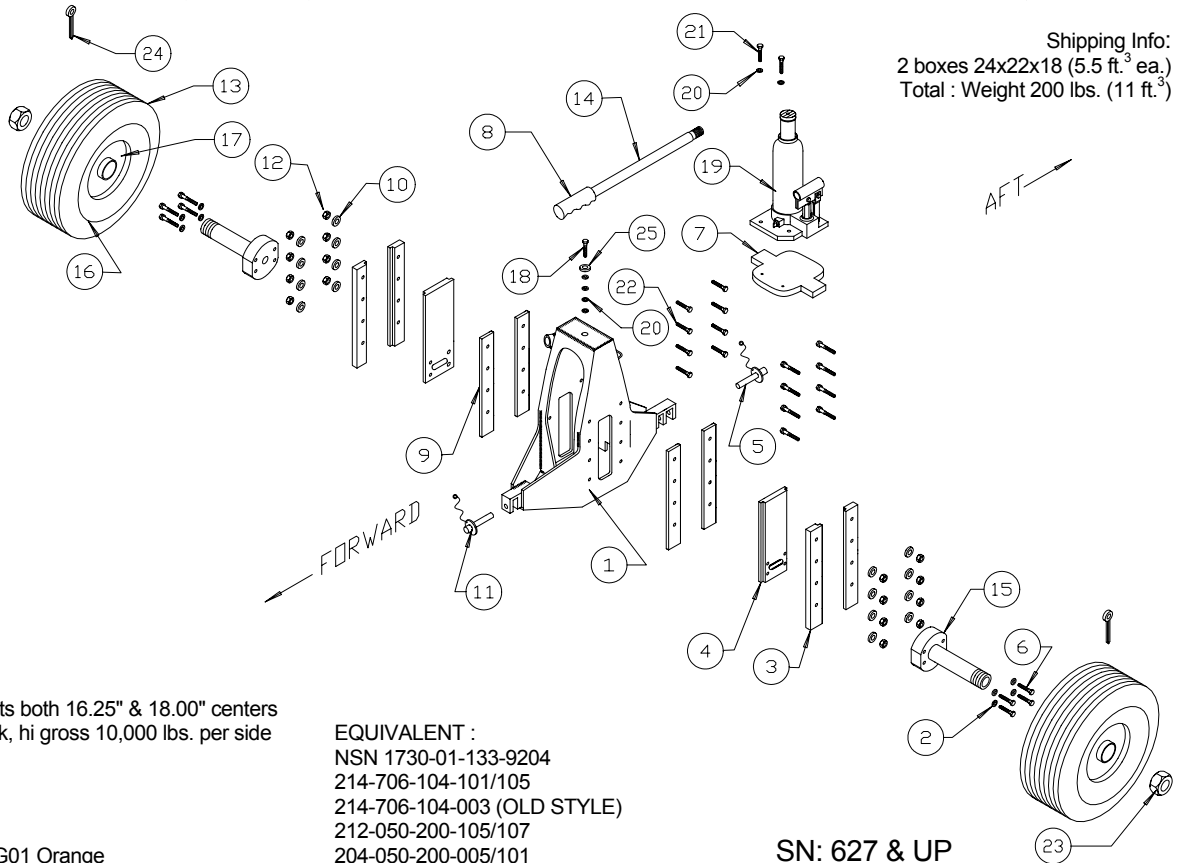

NOTE:
COMPLETE ASSEMBLIES
ARE SOLD IN SHIP SETS
WHICH CONSIST OF BOTH
THE LEFT AND THE RIGHT
SIDE, PARTS ARE LISTED
AS NUMBER REQUIRED
PER SIDE.

Specifications

Skid tube dia. 3.00" to 4.00"
Attach points, 2 ea. eye bolts fits both 16.25" & 18.00" centers
Operation - Hydraulic 8 ton jack, hi gross 10,000 lbs. per side
Tire size - 18x5.5, 105 psi
Approximate skid lift 3"
Weight each 95 lbs.
Dimensions 19x20x21
Paint: Powder Coated T009-0G01 Orange
HI-GROSS BELL 204, 205, 206L, 212, 222UT, 412, UH1, AH1, AH1W; AGUSTA A-119

EQUIVALENT :
NSN 1730-01-133-9204
214-706-104-101/105
214-706-104-003 (OLD STYLE)
212-050-200-105/107
204-050-200-005/101

SN: 627 & UP
MODEL:BDW-245A-1800

ITEM NO.	PART NUMBER	DESCRIPTION	NO REQ
	BDW-245A-1801	SINGLE SIDE ASSEMBLY	
1	W-245A-00	WELDED FRAME ASM.	1
2	WASHER LOCK 3/8	3/8 LOCK WASHER	8
3	W-245-05G	GUIDE	4
4	W-245-04G	AXLE SLIDE	2
5	CL8BLPB3.00C	BALL LOCK PIN	1
6	BOLT 3/8-24 X 1 1/4	BOLT	8
7	W-245A-09	JACK BASE NORCO	1
8	HG-1	HANDLE GRIP	1
9	W-245A-08	WARE PLATE	4
10	WASHER SAE 5/16	WASHER	16
11	CL8BPB2.00C	BALL LOCK PIN	1
12	NUT LOCK 5/16-18	LOCK NUT	16
13	W-18 X 5.5 TR	8 PLY TIRE	2
14	W-245-14-00	JACK HANDLE ASM.	1
15	W-245-11B	SPINDLE	2
16	W-5.30-8 TB	NON AIRCRAFT USE TUBE	2
17	40-117A	WHEEL	2
18	BOLT 1/4-20 X 1	BOLT STAINLESS STEEL	1
19	W-245-22C	8 TON JACK NORCO	1
20	WASHER LOCK 1/4	WASHER-SPLIT STYLE	6
21	BOLT ALLEN 1/4-20 X3/4	BOLT ALLEN HEAD	2
22	BOLT 5/16-18 X 1 1/4	BOLT	16

